



Othello Sofa

Why not ask your furniture stockist about our additional furniture collection and request a brochure or download one from our website www.sutcliffeurniture.co.uk to see our other stunning ranges of furniture:

Hampton, Kensington,
Kensington Ash, Amberley
and Upholstery.

Click Here For Prices

established
1887
SUTCLIFFE
furniture





established
1887
SUTCLIFFE Trafalgar Collection
furniture



Where quality and distinction are the Sutcliffe standard...

I am delighted to present our latest Trafalgar Teak brochure. The Trafalgar collection is made with real wood and real wood veneers in a Teak finish and bears all the hallmarks of traditional Sutcliffe craftsmanship. In this brochure we will show our extensive collection illustrating the comprehensive range of living, dining and occasional furniture.

Sutcliffe Furniture is a division of James H Sutcliffe & Son Ltd., a family owned, independent furniture manufacturer based in the Pennines.

We have been manufacturing fine furniture here in Todmorden since 1887, drawing on the skills of generations of local craftsmen and women.

All of our furniture is made in the UK and we are proud of our heritage in British manufacturing. In this brochure there are over sixty pieces of outstandingly crafted pieces of furniture for you to choose from which we can guarantee will suit any home interior.



Manufacturing
Guild Mark



Items shown on cover: Goodwood Dining Table with Droxford Chairs Display Unit 863TG and Hall Table 893

Items shown here: Trafalgar Dining Chairs, Goodwood Dining Table, Display Unit 863TG



**GREAT
BRITISH
FURNITURE**
Member of the British Furniture Manufacturers Association

G. Mitchell

George Mitchell, Chairman

Trafalgar Dining	3-4
Trafalgar Display	5-8
Trafalgar Living	9-10
Trafalgar Study	11-12
Trafalgar Visual	13-14
Trafalgar Audio	15
Trafalgar Occasional	16
Trafalgar Product Care	18



Trafalgar Dining

Items shown: Goodwood Dining Table,
Droxford Dining Chairs and Carvers, Mirror 900,
Sideboard 8491SB, Corner Display Unit 829

Sutcliffe Furniture has over 120 years experience of furniture making and without exception the Trafalgar Teak collection bears all the hallmarks of traditional Sutcliffe craftsmanship.

This all-embracing collection offers a choice of six dining tables, four with flip centre leaves for additional diners.

The flip centre leaf requires no real effort to extend your table when needed, so you are able to select the size of table as and when needed.

The Goodwood oval dining table encompasses Sutcliffe's design attributes with its elegant silhouette this table is both grand and functional with its flip centre leaf.

[Click Here For Prices](#)



**Compact Round Dining Table 239
with Arran Chairs and Carver**
LO:138cm (54½") LC:100cm (39½")
W:100cm (39") H:77cm (30½")
Arran Chair
H:96cm (37½")



**Goodwood Dining Table with Droxford
Chairs and Carver**
LO:196cm (77") LC:143cm (56½")
W:102cm (40") H:76cm (30½")
Droxford Chair
H:99cm (39")



**Dining Table 930 with Guildford
Chairs and Carver**
LO:165cm (65") LC:120cm (48")
W:80cm (31½") H:77cm (30½")
Guildford Chairs
H:100cm (39½")



Drop-leaf Dining Table 935 with Guildford Chair
1 Leaf Open:93cm (36½") 2 Leaf Open: 150cm (59")
Leaf Closed:35cm (14") W:100cm (39½") H:75cm (29½")



**Oval Dining Table 236 with Trafalgar
Chairs and Carvers**
LO:180cm (71") LC:141cm (55½")
W:93cm (37") H:76cm (30")
Trafalgar Chairs
H:100cm (39½")



Gate-leg Dining Table 235 with Arran Chair
1 Leaf Open:90cm (35½") 2 Leaf Open: 150cm (59")
Leaf Closed:28cm (11") W:90cm (35½") H:76cm (30")

For those who seek a smaller option the 236 is designed as a more condensed version of the Goodwood with its fluid lines for those seeking a design with sophistication but where space is a consideration.

Alternative options ideal for smaller lounges or dining rooms is the 239 a round table with pedestal leg but also has the flip extension to accommodate those additional diners when required.

The 935 large drop leaf table with its innovative pedestal leg is an ideal solution for those wanting to utilise space or alternately there is the more traditional option of the 235 gate-leg table. Both tables have individual leaf supports that allow for individual dining when folded, or the facility to effortlessly seat six diners when fully extended.

The contemporary 930 is a neat rectangular table which is compact in width but with

the flip centre can easily accommodate additional diners.

With all our Dining tables you can select from any of our four chairs, Droxford, Trafalgar, Arran and Guildford. All chairs come with a carver option.

All the chairs are made with solid wood frames. Importantly in the chair construction at Sutcliffe we use mortice and tenon joints to ensure longevity.



Trafalgar Display

Items shown: Display Unit 863,
Arran Dining Chairs, 236 Dining Table

The comprehensive range of wall and base units available within the Trafalgar collection will enhance any room setting.



Display Unit 863TG

H:188cm (74")
W:160cm (63")
D:47cm (18½")
Base H:77cm (30½")

Mirrored back optional **863TGM**



Combination Unit 863

H:188cm (74")
W:160cm (63")
D:47cm (18½")
Base H:77cm (30½")

Mirrored back optional **863M**



Display Unit 848

H: 188cm (74")
W:121cm (47½")
D:47cm (18½")
Base H:77cm (30½")

Mirrored back optional **848M**



Combination Unit 850

H:188cm (74")
W:121cm (47½")
D:47cm (18½")
Base H:77cm (30½")

Mirrored back optional **850M**



Corner Unit 819MS

H:188cm (74")
Base H:66cm (26")
Mirrors as standard

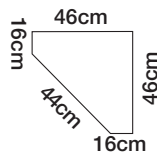

Corner Display Unit 829

H:188cm (74")
Mirrors as standard

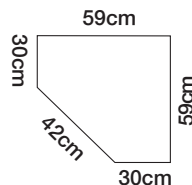

Display Unit 833

H:188cm (74")
W: 81cm (32")
Base H:77cm (30½")
D:47cm (18½")

Mirrored back optional **833M**



Display Unit 933

H:145cm (57")
W 62cm (24")
D:33.5cm (13")

Mirrored back optional **933M**

Trafalgar Display offers a comprehensive range of dressers and sideboards to enable you to both store items and show off those proud possessions to their best advantage. The cleverly concealed down lighting offers a subtle illumination which will further enhance your ornamental display.

Corner units 819 and 829 come with mirror backs as standard for ultimate display. 833, 933, 863TG, 863, 848, 850 have a mirrored back option available.

All Base Units have half depth shelves as standard to outer cupboards.

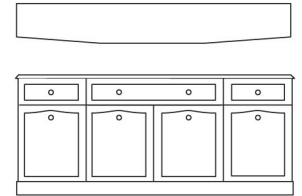

Sideboard 8631SB

H:77cm (30½")
W:160cm (63")
D:49cm (19½")

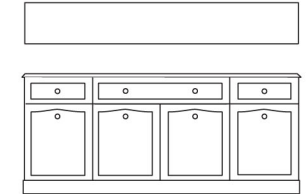

Base Unit 863B

H:77cm (30½")
W:160cm (63")
D:47cm (18½")

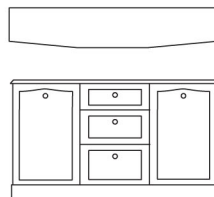

Sideboard 8491SB

H:77cm (30½")
W:121cm (47½")
D:49cm (19½")

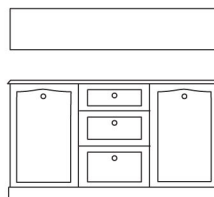

Base Unit 849B

H:77cm (30½")
W:121cm (47½")
D:47cm (18½")

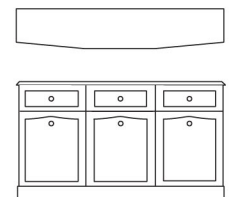

Sideboard 8501SB

H:77cm (30½")
W:121cm (47½")
D:49cm (19½")

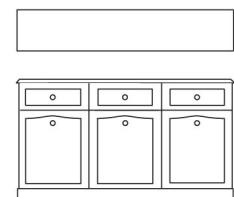

Base Unit 850B

H:77cm (30½")
W:121cm (47½")
D:47cm (18½")



Base Unit 833B

H: 77cm (30½")
W: 81cm (32")
D: 47cm (18½")



Mirror 900

Can be hung landscape or portrait
100cm x 77cm (39½") x (30")

A comprehensive selection of Base Units and Sideboards are available in a variety of widths. A Sideboard will have a canted top and a Base Unit will have a parallel edged top.



Trafalgar Display

Items shown: Sideboard 8491SB,
Guildford Dining Chairs, 930 Table, 900 Mirror

With our attention to quality we use dove tail joints on all our drawers.

Both Sideboards and Base Units can have cutlery inserts as an optional extra.

Trafalgar offers a bevelled glass Mirror with a solid wood frame emulating the Trafalgar Collection which can be hung portrait or landscape.

All Base Units and Sideboards have half depth shelves as standard to outer cupboards.



Trafalgar Living

Trafalgar Living covers audio visual display and storage, library and home study and a large choice of those all essential occasional tables.



Items shown: Wide Screen TV Unit 942, Magazine Rack 821, Nest 922, Tall Side Table 916, Display Unit 833, Goodwood Dining Table with Droxford Dining Chairs, Display Unit 933, Chair from the Othello Sofa Collection



Trafalgar Study

Items shown: Console Table/Desk
936, Bookcase with 2 Doors 252,
Tall Bookcase 270, Guildford Chair

Collectors of Trafalgar range will find this large selection of study furniture an asset for library and home IT equipment. It all complements the Trafalgar range whilst being extremely functional too.



Bookcase with 2 doors 252
H:140cm (55")
W:78cm (31")
D:30cm (12")



Small Bookcase 238
H:92cm (36")
W:78cm (31")
D:30cm (12")



Bureau 923
H:100cm (39½")
W:82cm (32½")
D:47cm (18½")
Bureau comes with lock as optional extra



Console Table/Desk 936
H:79cm (31")
W:87cm (34½")
D:50cm (17½")



Medium Bookcase 250
H: 122cm (48")
W: 78cm (31")
D: 30cm (12")



Tall Bookcase 270
H: 184cm (72½")
W: 78cm (31")
D: 30cm (12")

Trafalgar bookcases all come in the same width but with a choice of heights.

All come with adjustable shelves to accommodate book height. Tall Bookcase 270 centre shelf is fixed.

The Bureau 936 and Console Desk table offer contemporary solutions for IT equipment.



Wall Mounted Shelf 210WM
H:12.5cm (5") L:60cm (24")
D:17cm (7")



Wall Mounted Shelf 211WM
H:12.5cm (5") L:74cm (29")
D:17cm (7")



Trafalgar Visual

Items shown: Entertainment Unit 957, Sofa Table 928, Occasional Table with Magazine Rack 821, Chair from the Caderra Sofa Collection

Televisions are always changing in size. Trafalgar offers TV/DVD units that suit all sizes from small to grand. Also available are corner units with add on units to create an extra large surface whilst offering important storage requirements.



Corner TV/DVD Unit 217
H:57cm (22½") W:100cm (39½")
D:49cm (19½")
Internal
H:43cm (17") W:43cm (17")
D:39cm (15")



2 Door TV/DVD Unit 832
H:49cm (19½") W:77cm (30½")
D:47cm (18½")
Internal
H:34cm (13") W:67cm (26")
D:39cm (15")



1 Drawer TV/DVD Unit 834
H:49cm (19½") W:77cm (30½")
D:47cm (18½")
Internal
H:17.5cm (7") W:70cm (27½")
D:42cm (16½")



TV/DVD Unit for Widescreen TV 942
H:51cm (20") W:100cm (39½") D:46cm (18")
Internal
H:40cm (16") 2 adjustable shelves
in each compartment
W:44cm (17½") D:42cm (16½")



Entertainment Unit for Widescreen TV 957
H:51cm (20") W:146cm (57½")
D:46cm (18½")
Internal
H:40cm (16") 2 adjustable shelves
in each compartment
W:44cm (17½") D:42cm (16½")



Items shown: Corner TV/DVD Unit 218,
6 Drawer Base Unit 234 and 231 Side Base
Unit, Gate Leg Coffee Table 924, Chair from
the Othello Sofa Collection

Corner TV/DVD Unit 218
H:56cm (22") W:113cm (44½") D:60cm (24")
Internal
H:43cm (17") W:43cm (17") D:39cm (15")

Low-6 Drawers Unit 234
H:56cm (22") W:79cm (31") D:46cm (18")

Low Single Door Unit 231R (Right Hand Hinge)
H:56cm (22") W:39cm (15½") D:46cm (18")
Low Single Door Unit 231L (Left Hand Hinge)
H:56cm (22") W:39cm (15½") D:46cm (18")

All internal measurements are given to
accommodate media equipment.

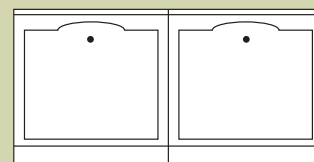

Low 2-Door Unit 232
H:56cm (22") W:79cm (31")
D:46cm (18")



CD/DVD Storage Unit 815

H:81cm (32")
W:48cm (19")
D:22cm (8½")



CD/DVD Storage Unit 818S

H:81cm (32")
W:64cm (25½")
D:23cm (9")



CD/DVD Storage Unit 818

H:81cm (32")
W:64cm (25½")
D:23cm (9")



**Audio Visual Storage
Cabinet 220**

H:84cm (33") W:48cm (19") D:49cm (19½")
Internal
H:71cm (28") W:37cm (14½") D:43cm (17")



CD/DVD Storage Unit 822

H:92.5cm (36½")
W:55cm (21½")
D:36.5cm (14½")



Trafalgar Audio

From Sound Systems to Hi-Fi Systems, Trafalgar offers display and finds a home for the storage of DVDs and CDs.



Sofa Table 928

H:51cm (20") W:120cm (47")
D:58cm (23")



Coffee Table 918

H:43cm (17") W:100cm (39")
D:46cm (18")



Tall Side Table 916

H:78cm (31") W:45cm (17½")
D:40cm (15½")



Hall Table 893

H:78cm (31") W:84cm (33")
D:38cm (15")



**Sofa Table with pull-out
heat resistant sides 835**

H:51cm (20") OW:143cm (56½")
CW:90cm (35½") D:46cm (18")



Gate Leg Coffee Table 924

1 Leaf Open:66cm (26") 2 Leaf Open:100cm (39½")
Leaf Closed:33cm (13") W:62.5cm (25") H:51cm (20")



Nest of Tables 922

H:47cm (18½") W:55cm (22")
D:40cm (15½")



Lamp Table 820

H:51cm (20") W:52cm (20½")
D:46cm (18")



**Occasional Table with
Magazine Rack 821**

H:50cm (19½") W:52cm (20½")
D:33cm (13")



Nest of Tables 867

H:51cm (20") W:52cm (20½")
D:46cm (18")



Glass Top Sofa Table 947G

H:50cm (19½") W:114cm (45")
D:50cm (19½")



Sofa Table 947

H:50cm (19½") W:114cm (45")
D:50cm (19½")



Large supper table 844

H:41cm (16") W:113cm (44½")
D:64cm (25½")

Trafalgar Occasional

Beautiful Trafalgar has over twelve occasional tables to choose from.
With a choice of tall, hall, coffee, sofa, nest and magazine rack with table.



Items shown: Bureau 923, Guildford Chair

Why Trafalgar?

We believe we have ten good reasons...

Proud of our heritage, we have been producing furniture since 1887.

Collectors of Trafalgar will find a piece of furniture to suit every need.

We have been awarded the prestigious Guild Mark for Furniture design and manufacture.

All our furniture is British designed and manufactured.

All our timbers are sourced from sustainable forests.

Trafalgar is continually evolving creating new cabinet to meet modern home needs.

It is collectable.

We use dove tail joints in all our drawers.

We use mortice and tenon joints in all our chair joints.

All timbers and veneers are hand selected.

Care of cabinet

To keep your cabinet in good condition, we recommend that, in addition to regular dusting with a soft, clean duster, an occasional wipe with a chamois leather rinsed in a mild detergent solution is beneficial.

Any spillage should be removed at once. Proprietary sprays and polishes **MUST NOT BE USED**.

Please avoid heat and rough objects which may scratch the surface of the furniture.

Further instructions regarding your particular item of furniture are attached to each individual item where applicable.

Wood is a natural material and so will vary in grain and colour.

Wood will mellow subtly with age.

All measurements are approximate.

established
1887
SUTCLIFFE
furniture



Manufacturing
Guild Mark